

# [thecarversite.com](http://thecarversite.com)

This manual is either an original scan from tech's who worked at Carver corp, donated by forum members, or both. These manuals are NOT intended for re-sale. If you purchased a 'Carver Manuals' disc on ebay or another auction site, and it has this material on it, you were ripped off!

Please report any resale of this material to us at [thecarversite.com](http://thecarversite.com)

# [thecarversite.com](http://thecarversite.com)

38

# CARVER

**Powerful • Musical • Accurate**

## C-3 PREAMPLIFIER SERVICE MANUAL

| <b>CONTENTS</b>                                | <b>Page</b> |
|--|-------------|
| SAFETY INFORMATION .....                       | 3           |
| SPECIFICATIONS .....                           | 4           |
| BLOCK DIAGRAM .....                            | 4           |
| SCHEMATIC DIAGRAM .....                        | 5-6         |
| EXPLODED VIEW AND PARTS LIST .....             | 7-9         |
| PCB COMPONENT SIDE VIEWS AND PARTS LISTS ..... | 10-14       |

C-3 Carver

# CARVER Corporation

---

**SHIP TO:**

20121 48th Ave. West  
Lynnwood Wa. 98036  
(206) 775-6245

**MAIL TO:**

P.O. Box 1237  
Lynnwood Wa. 98046-1237

**Published by:**

CARVER Corporation  
20121 48th Avenue West  
Lynnwood, WA 98036  
(206) 775-6245

©1992 by CARVER Corporation  
All Rights reserved.  
Printed in Taiwan

No part of this publication may be reproduced, stored in a data base or retrieval system, or transmitted in any form by any means electronic, mechanical, photocopying, recording or otherwise, without the prior written permission of the CARVER Corporation.

# SAFETY INFORMATION

## WARNING.

Any person performing the procedures described in this manual will be exposed to hazardous voltages and the risk of electric shock.

Carver Corporation assumes that any person who removes the cover from the unit has been properly trained in protecting against avoidable injury and shock.

Therefore, the procedures described here are to be performed by qualified electronics service personnel only.

We recommend that the unit be tested only when line isolation is provided by an isolation transformer. The line cord of the unit must be disconnected and the power supply fully discharged before any components are replaced. Failure to do so may result in severe damage to the unit and the risk of electric shock.

The safety tests described below must be performed properly.

## CAUTION:

Before returning the unit to the customer, one of the following safety tests must be performed.



1. Check the leakage current. Connect the unit to 120 VAC supply and turn the power switch "ON". Using an ammeter, measure the current between the neutral side of the AC supply and chassis ground of the unit under test. If leakage current exceeds 0.5mA, the unit is defective.

Reverse the polarity of the AC supply and repeat.

2. Measure the resistance from either side of the linecord to chassis ground. If it is less than 500k ohms, the unit is defective.

**WARNING - DO NOT** return the unit to the customer if it fails one of these tests until the problem is located and corrected.

## CAUTION

|  |   |   |
|--|---|---|
|   | <b>CAUTION</b><br>RISK OF ELECTRIC SHOCK<br>DO NOT OPEN |  |
| <b>CAUTION: TO REDUCE THE RISK OF ELECTRIC SHOCK<br/>DO NOT REMOVE COVER (OR BACK)<br/>NO USER-SERVICEABLE PARTS INSIDE<br/>REFER SERVICING TO QUALIFIED PERSONNEL</b> |   |   |



The lightning flash with arrowhead symbol within an equilateral triangle is intended to alert the user to the presence of uninsulated "dangerous voltage" within the product's enclosure, that may be of sufficient magnitude to constitute a risk of electric shock to persons.



The exclamation point within an equilateral triangle is intended to alert the user of the presence of important operating and maintenance (servicing) instructions in the literature accompanying the appliance...

# SPECIFICATIONS

## Specifications for the C-3 Preamplifier

|   |  |  |
|---|--|--|
| <b>Frequency Response</b>   |  |  |
| Phono:  |  | RIAA 20Hz to 20kHz (+/- 1dB)   |
| Line Level Inputs:  |  | 20Hz to 20kHz (+0, - 0.5dB)  |
| <b>Gain</b>   |  |  |
| Phono:  |  | 57dB (+/-1dB) at 1kHz, measured at Main Out with Master Volume fully CW          |
|   |  | 37dB (+/-1dB) at 1kHz, measured at Tape Out                                      |
| Line Level Inputs:  |  | 20dB (+/-1dB) at Main Out with Master Volume fully CW                            |
|   |  | 0dB (+/-1dB) at Tape Out   |
| <b>Channel Balance:</b>   |  |  |
| <b>Signal-to-Noise Ratio (IHF A-weighted)</b>                             |  |  |
| Phono:  |  | 80dB at Tape Out, below an input reference of 5mV rms at 1kHz                    |
| Line Level Inputs:  |  | 82dB at Preamp Out, below 0.5V rms output level at 1kHz, with gain set for unity |
| <b>THD:</b>   |  |  |
| <b>Sensitivity (for 0.5V rms at Main Out with Master Volume fully CW)</b> |  |  |
| Phono:  |  | 705µV rms  |
| Line Level Inputs:  |  | 50mV rms   |
| <b>Maximum Input Signal</b>   |  |  |
| Phono:  |  | 11mV rms   |
| Line Level Inputs:  |  | 800mV rms  |
| <b>Input Impedance</b>  |  |  |
| Phono:  |  | 47 kilohms   |
| Line Level Inputs:  |  | 50 kilohms   |
| <b>Maximum Output</b>   |  |  |
| Main Out:   |  | 6V rms into 1 kilohm   |
| Headphone Out:  |  | 1.9V rms into 60Ω (60mW)   |
|   |  | 6.5Vrms into 600Ω (70mW)   |
| <b>Output Impedance:</b>  |  |  |
|   |  | 600 ohms, Main Out and Tape Out  |
| <b>Tone Controls</b>  |  |  |
| Treble:   |  | +/-12dB (+/-1dB) at 10kHz  |
| Bass:   |  | +/-12dB (+/-1dB) at 100Hz  |
| <b>Loudness:</b>  |  |  |
|   |  | +7dB at 100Hz, gain set at -10dB   |
| <b>Sonic Hologram Generator</b>   |  |  |
| Image Resolution:   |  | 5° horizontal; 20° vertical  |
| <b>Power Consumption:</b>   |  | 11W  |
| <b>Power Requirements:</b>  |  | 120VAC/60Hz (USA and Canada)<br>Other voltages as required for export            |
| <b>Size (H x W x D):</b>  |  | 2" x 19" x 12" (13" overall)<br>51mm x 483mm x 305mm (330mm overall)             |
| <b>Weight</b>   |  |  |
| Net Weight:   |  | 8.75 lbs.<br>4.0 kg  |
| Shipping Weight:  |  | 11.25 lbs.<br>5.1kg  |

### BLOCK DIAGRAM

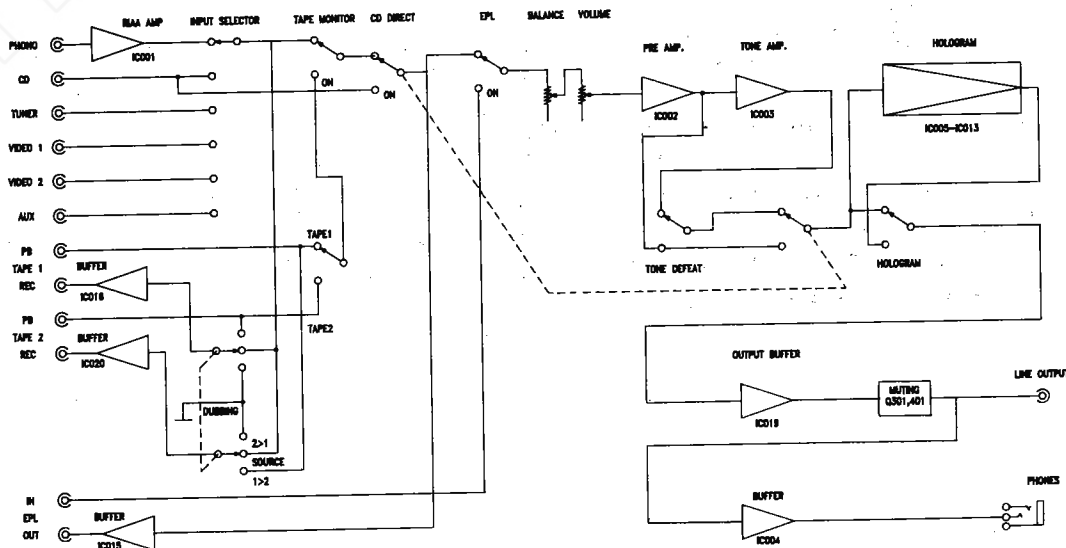

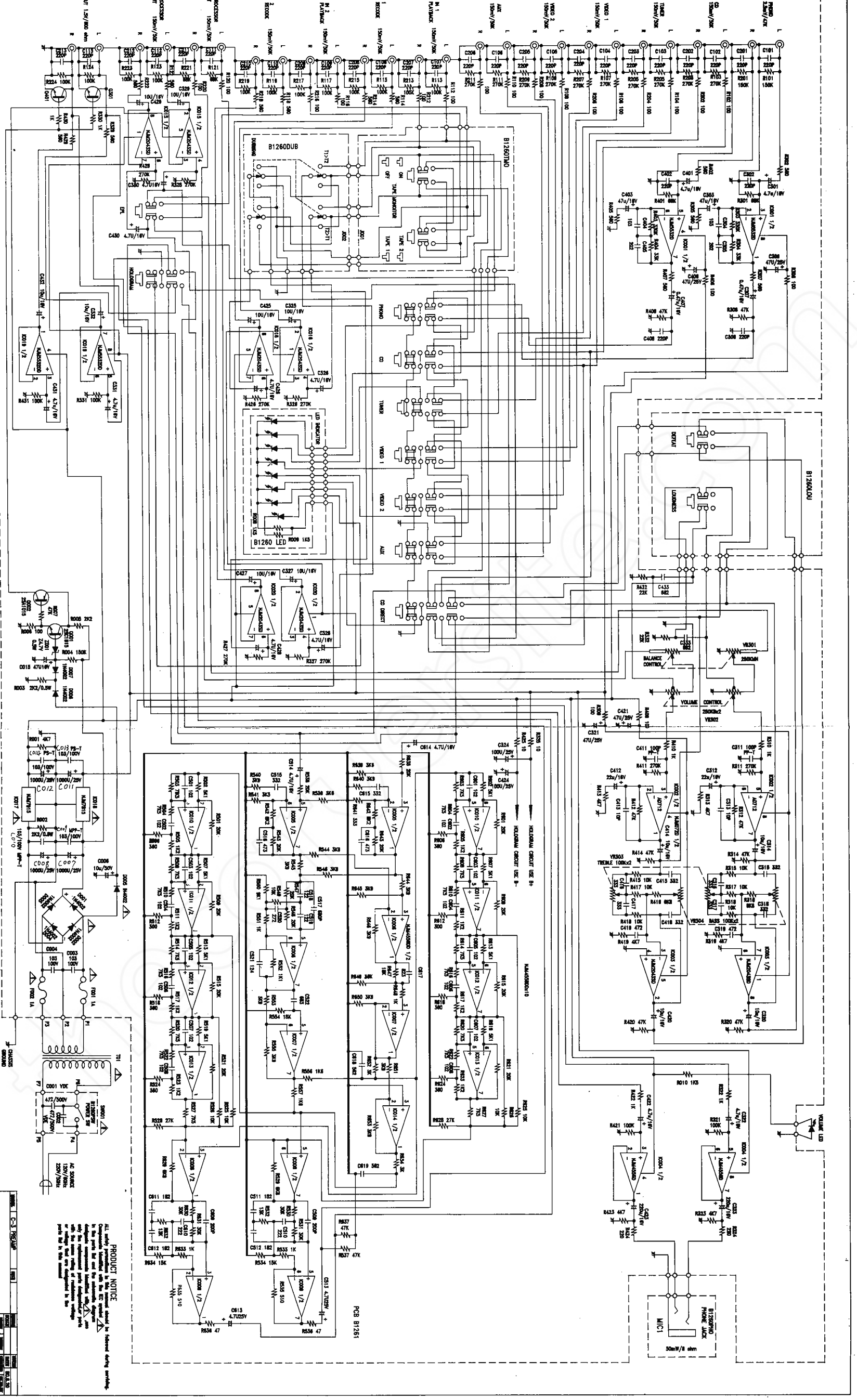



**PRODUCT NOTICE**  
 All product numbers are indicated by reference designations. Components are shown in the schematic diagram. Components are shown in the schematic diagram. Components are shown in the schematic diagram.

|             |            |            |        |
|-------------|------------|------------|--------|
| MODEL       | C-3 TRIPLE | REV        | 1.0    |
| DATE        | 5-2-68     | BY         | WJL    |
| DESIGNED BY | WJL        | CHECKED BY | WJL    |
| APPROVED BY | WJL        | DATE       | 5-2-68 |
| COMPONENTS  | COLL.      | DATE       |        |
| PCB         | WJL        | DATE       |        |

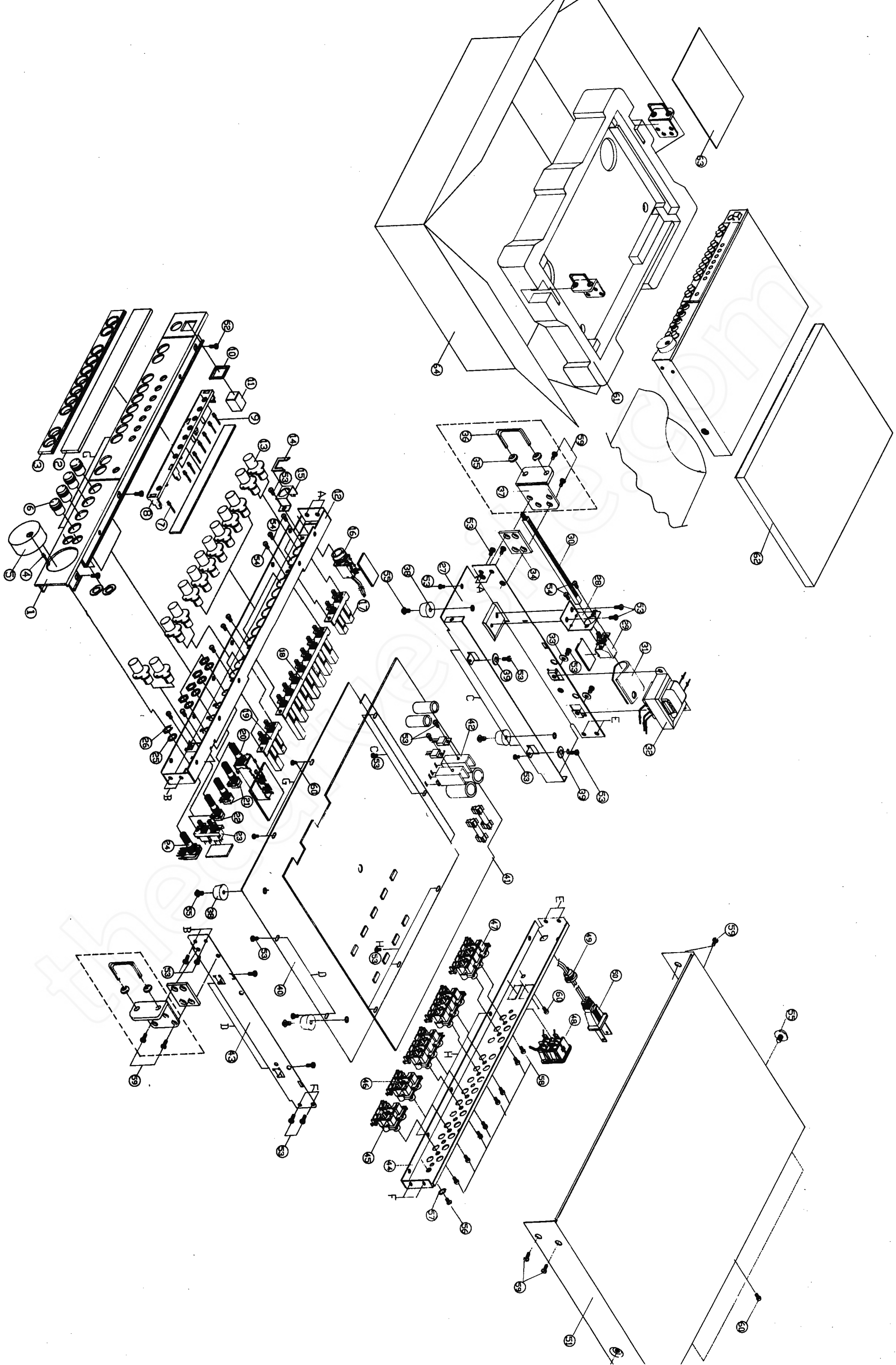
PARTS VALUE TO CHANGE WITHOUT NOTICE



# EXPLOD PART LIST

| NO. | DESCRIPTION                   | P/N        | Q'TY  |
|-----|-------------------------------|------------|---|
| 1.  | AL PANEL L - 366              | 78L366**** | 1   |
| 2.  | ACRYLIC PANEL A - 377         | 85A377**** | 1   |
| 3.  | PLASTIC FRAME, POWER A - 382  | 78A382**** | 1   |
| 4.  | LED 2 φ, GREEN                | 16025***** | 1   |
| 5.  | KNOB KB - 270                 | 80KB270*** | 1   |
| 6.  | KNOB KB - 269                 | 80KB269*** | 4   |
| 7.  | LED 3φ, L - 32ED (YELLOW)     | 1603I32ED* | 1   |
| 8.  | PLASTIC FRAME, LED A - 380    | 78A380**** | 1   |
| 9.  | LED 3φ, L - 32YD (YELLOW)     | 1603L32YD* | 7   |
| 10. | WASHER, PUSH BUTTON A - 381   | 88WA381*** | 1   |
| 11. | PUSH BUTTON KB - 277          | 80KB277*** | 1   |
| 12. | FRONT PANEL C - 1617          | 78C1617*** | 1   |
| 13. | PUSH BUTTON KB - 268          | 80KB268*** | 13  |
| 14. | SPRING PLATE, PHONE           | 88SPC3**** | 1   |
| 15. | HOLDER FOR PHONE C - 1616     | 78C1616*** | 1   |
| 16. | EAR PHONE JY6318 - 01 - 030   | 28JY631801 | 1   |
| 17. | PUSH SWITCH SPU22A002         | 20UN22A002 | 1   |
| 18. | PUSH SWITCH SPUN72A007        | 20UN72A007 | 1   |
| 19. | PUSH SWITCH SPUN22A019        | 20UN22A019 | 1   |
| 20. | ROTATE SWITCH SRR2V43N25      | 21R2V43N25 | 1   |
| 21. | VR RK0971210063 100KBx2       | 32100KBx2* | 2   |
| 22. | VR RK0971210066 250KMNx2      | 32250KMNx2 | 1   |
| 23. | PUSH SWITCH SPEC21HA02        | 20EC21HA02 | 1   |
| 24. | VR RK16312AS170 250KAx2       | 32250KAx2* | 1   |
| 25. | WASHER 3φ                     | 88WF03P14W | 1   |
| 26. | NUT M3                        | 88N603W*** | 1   |
| 27. | CHASSIS (RIGHT) C - 1625      | 78C1625*** | 1   |
| 28. | HOLDER C - 1649               | 78C1649*** | 1   |
| 29. | POWER SWITCH TV - 3           | 20DLB1027* | 1    |
| 30. | LINK, FOR PUSH BUTTON A - 269 | 85A269**** | 1   |
| 31. | UL TUBE 30 φ                  | 6230L40VW1 | 1   |
| 32. | TRANSFORMER (120V)            | 701065120* | 1    |
|     | TRANSFORMER (220V)            | 701065220* | 1   |
| 33. | WASHER, 3φ                    | 88WF3***** | 1  |
| 34. | WASHER, RUBBER E - 242        | 81E242**** | 2   |
| 35. | AL PAD FOR HOLDER H - 214     | 76H214**** | 1   |
| 36. | HOLDER H - 257                | 76H257**** | 1   |
| 37. | AL SIDE PLATE L - 373         | 78L373**** | 2   |
| 38. | FOOT CUSHION 16x7.5M/M        | 81016x7P5* | 4   |
| 39. | WASHER SPRING 3φ              | 88WS03P6** | 1   |
| 40. | BOTTOM PLATE C - 1619         | 78C1619*** | 1   |
| 41. | P. C. BOARD B - 1261          | 97B1261*** | 1   |
| 42. | HEAT SINK H - 198             | 76H198**** | 2   |
| 43. | CHASSIS (RIGHT) C - 1626      | 78C1626*** | 1   |
| 44. | REAR PLATE C - 1624           | 78C1624*** | 1   |
|     | REAR PLATE C - 1663 EXV       | 78C1663EXV | 1 EXV   |
| 45. | RCA JACK RT - 1019 - 010 - G  | 55RJ101910 | 1   |
| 46. | RCA JACK #204 - 1             | 552R2041** | 1   |
| 47. | RCA JACK HSP - #206 - 1       | 55RJ2061** | 3   |
| 48. | AC SOCKET AC - 004            | 55AC004*** | 2  |
| 49. | AC WIRE CLIP SB4F             | 96SB4F**** | 1  |
|     | AC WIRE CLIP 6W - 2 EXV       | 966W2***** | 1  |
| 50. | AC CORD 2 P VDE EXV           | 682PVDE2B* | 1  |
|     | AC CORD SPT - 2               | 682SPT22B* | 1  |
| 51. | UPPER COVER C - 1618          | 78C1618*** | 1   |
| 52. | SCREW CFTS 3x6 (B)            | 88ST0306FB | 3   |
| 53. | SCREW CRTS 3x6 (Y)            | 88ST0306RY | 26  |
| 54. | SCREW CRMS 3x6 (Y)            | 88SM0306MY | 8   |
| 55. | SCREW CRWMS 4x6 (B)           | 88SM0406MB | 6   |
| 56. | SCREW CRWMS 4x8 (W)           | 88SM0408MW | 1   |
| 57. | SCREW CRMS 3x6 (Y)            | 88SM0306RY | 10  |
| 58. | SCREW 1/8X9 (B)               | 88SME809RB | 8   |
| 59. | SCREW CRWMS 4x10 (B)          | 88SM0410RB | 4   |
| 61. | STYROFOAM PF - 132            | 97PF132*** | 1   |
| 62. | STYROFOAM PF - 128            | 97PF128*** | 1   |
| 63. | OWNER'S MANUAL C - 3          | 91C3*****  | 1   |
| 64. | GIFT BOX                      | 93C3*****  | 1   |



**P. C. BOARD B - 1261 ASS'Y**

| REF. NO  | DESCRIPTION | P/N         | Q'TY |
|--|-------------|-------------|------|
| <b>CARBON RESISTORS T - TYPE ALL RESISTORS</b> |             |             |      |
| <b>RATED ARE +/- 5% TOLERANCE AND 1/6W</b>     |             |             |      |
| R536, R636                                     | 47 OHM      | 300047C6TJ  | 2    |
| R108, R110, R112, R206                         | 100 OHM     | 300100C6TJ  | 4    |
| R208, R210, R212                               | 100 OHM     | 300100C6TJ  | 3    |
| R103, R203                                     | 300 OHM     | 300300C6TJ  | 2    |
| R506, R528, R524,                              | 360 OHM     | 300360C6TJ  | 3    |
| R606, R618                                     | 360 OHM     | 300360C6TJ  | 2    |
| R535, R635                                     | 510 OHM     | 300510C6TJ  | 2    |
| R122, R114, R118, R214,                        | 560 OHM     | 300560C6TJ  | 4    |
| R218, R222, R302, R402                         | 560 OHM     | 300560C6TJ  | 4    |
| R533, R551, R633, R648                         | 1K OHM      | 30001K C6TJ | 4    |
| R552   | 1K1 OHM     | 3001K1C6TJ  | 1    |
| R505, R511, R517, R523,                        | 1K2 OHM     | 3001K2C6TJ  | 4    |
| R605, R611, R617, R623                         | 1K2 OHM     | 3001K2C6TJ  | 4    |
| R556   | 1K6 OHM     | 3001K6C6TJ  | 1    |
| R654   | 3K OHM      | 30003K C6TJ | 1    |
| R541, R641                                     | 3K3 OHM     | 3003K3C6TJ  | 2    |
| R540, R545, R553, R555,                        | 3K9 OHM     | 3003K9C6TJ  | 5    |
| R640, R644, R645, R646,                        | 3K9 OHM     | 3003K9C6TJ  | 5    |
| R650, R653                                     | 3K9 OHM     | 3003K9C6TJ  | 2    |
| R502, R507, R513, R519,                        | 5K1 OHM     | 3005K1C6TJ  | 4    |
| R602, R607, R613, R619                         | 5K1 OHM     | 3005K1C6TJ  | 4    |
| R521, R629                                     | 6K8 OHM     | 3006K8C6TJ  | 2    |
| R503, R504, R508, R510,                        | 7K5 OHM     | 3007K5C6TJ  | 4    |
| R514, R516, R520, R522,                        | 7K5 OHM     | 3007K5C6TJ  | 4    |
| R527, R603, R604, R608,                        | 7K5 OHM     | 3007K5C6TJ  | 4    |
| R610, R614, R616, R620,                        | 7K5 OHM     | 3007K5C6TJ  | 4    |
| R622, R627, R642, R627,                        | 7K5 OHM     | 3007K5C6TJ  | 4    |
| R542   | 8K2 OHM     | 3008K2C6TJ  | 2    |
| R542, R642                                     | 9K1 OHM     | 3009K1C6TJ  | 1    |
| R555   | 10K OHM     | 30010K C6TJ | 3    |
| R525, R526, R549,                              | 10K OHM     | 30010K C6TJ | 2    |
| R625, R626                                     | 13K OHM     | 30013K C6TJ | 2    |
| R532, R632                                     | 15K OHM     | 30015K C6TJ | 2    |
| R534, R634                                     | 18K OHM     | 30018K C6TJ | 1    |
| R647   | 20K OHM     | 30020K C6TJ | 4    |
| R501, R509, R515, R521,                        | 20K OHM     | 30020K C6TJ | 4    |
| R543, R547, R548, R601,                        | 20K OHM     | 30020K C6TJ | 4    |
| R609, R615, R621, R643                         | 20K OHM     | 30020K C6TJ | 4    |
| R528   | 27K OHM     | 30027K C6TJ | 1    |
| R530, R531, R630, R631                         | 30K OHM     | 30030K C6TJ | 4    |
| R537, R637                                     | 47K OHM     | 30047K C6TJ | 2    |
| R121, R221                                     | 68K OHM     | 30068K C6TJ | 2    |
| R113, R115, R117, R119,                        | 100K OHM    | 30100K C6TJ | 4    |
| R123, R124, R213, R215,                        | 100K OHM    | 30100K C6TJ | 4    |
| R217, R219, R223, R224                         | 100K OHM    | 30100K C6TJ | 4    |
| R101, R201                                     | 150K OHM    | 30150K C6TJ | 2    |
| R103, R105, R107, R109,                        | 270K OHM    | 30270K C6TJ | 4    |
| R111, R203, R205, R207,                        | 270K OHM    | 30270K C6TJ | 4    |
| R209, R211, R326, R327,                        | 270K OHM    | 30270K C6TJ | 4    |
| R328, R426, R427, R428                         | 270K OHM    | 30270K C6TJ | 4    |
| <b>CARBON RESISTORS T - TYPE ALL RESISTORS</b> |             |             |      |
| <b>RATED ARE +/- 5% TOLERANCE AND 1/4W</b>     |             |             |      |
| R325, R425                                     | 10 OHM      | 300010C4TJ  | 2    |
| R108, R208                                     | 10 OHM      | 300010C4TJ  | 2    |
| R006, R102, R104, R106                         | 100 OHM     | 300100C4TJ  | 4    |
| R116, R120, R204, R216,                        | 100 OHM     | 300100C4TJ  | 4    |
| R220, R216, R306, R309,                        | 100 OHM     | 300100C4TJ  | 4    |
| R406, R407                                     | 100 OHM     | 300100C4TJ  | 2    |
| R324, R424                                     | 220 OHM     | 300220C4TJ  | 2    |
| R624   | 360 OHM     | 300360C4TJ  | 1    |
| R305, R307, R329, R405,                        | 560 OHM     | 300560C4TJ  | 4    |
| R407, R429                                     | 560 OHM     | 300560C4TJ  | 2    |
| R310, R322, R330, R410,                        | 1K OHM      | 30001K C4TJ | 4    |
| R422, R433                                     | 1K OHM      | 30001K C4TJ | 2    |
| R010, R557                                     | 1K5 OHM     | 3001K5C4TJ  | 2    |
| R005   | 2K2 OHM     | 3002K2C4TJ  | 1    |

| REF. NO  | DESCRIPTION       | P/N         | Q'TY |
|--|-------------------|-------------|------|
| <b>CARBON RESISTORS T - TYPE ALL RESISTORS</b> |                   |             |      |
| <b>RATED ARE +/- 5% TOLERANCE AND 1/2W</b>     |                   |             |      |
| R552   | 3K OHM            | 30003K C4TJ | 1    |
| R544, R546, R651                               | 3K9 OHM           | 3003K9C4TJ  | 3    |
| R001, R313, R319, R323,                        | 4K7 OHM           | 3004K7C4TJ  | 4    |
| R413, R419, R423                               | 4K7 OHM           | 3004K7C4TJ  | 3    |
| R316, R416                                     | 6K8 OHM           | 3006K8C4TJ  | 2    |
| R315, R317, R318, R415,                        | 10K OHM           | 30010K C4TJ | 4    |
| R417, R418                                     | 10K OHM           | 30010K C4TJ | 2    |
| R647   | 18K OHM           | 30018K C4TJ | 4    |
| R538, R638                                     | 20K OHM           | 30020K C4TJ | 2    |
| R332, R432                                     | 22K OHM           | 30022K C4TJ | 2    |
| R628   | 27K OHM           | 30027K C4TJ | 1    |
| R304, R404                                     | 33K OHM           | 30033K C4TJ | 2    |
| R007, R308, R312, R314,                        | 47K OHM           | 30047K C4TJ | 4    |
| R320, R408, R412, R414,                        | 47K OHM           | 30047K C4TJ | 4    |
| R420   | 68K OHM           | 30068K C4TJ | 1    |
| R301, R401                                     | 100K OHM          | 30100K C4TJ | 2    |
| R321, R331, R421, R431                         | 150K OHM          | 30150K C4TJ | 4    |
| R004   | 270K OHM          | 30270K C4TJ | 1    |
| R311, R411                                     | 330K OHM          | 30330K C4TJ | 2    |
| R303, R403                                     | 330K OHM          | 30330K C4TJ | 2    |
| <b>CARBON RESISTORS T - TYPE ALL RESISTORS</b> |                   |             |      |
| <b>RATED ARE +/- 5% TOLERANCE AND 1/2W</b>     |                   |             |      |
| R002, R003                                     | 2K2 OHM           | 3002K2C2TJ  | 1    |
| <b>CAPACITORS</b>                              |                   |             |      |
| C313, C413                                     | 10P/500V CERAMIC  | 42010P5ARJ  | 2    |
| C308, R408                                     | 100P/50V CERAMIC  | 42100P50RJ  | 2    |
| C509, C609                                     | 200P/500V CERAMIC | 42200P5ARJ  | 2    |
| C101 - C113, C302,                             | 220P/500V CERAMIC | 42220P5ARJ  | 14   |
| C201 - C213, C308,                             | 220P/500V CERAMIC | 42220P5ARJ  | 14   |
| C402, C408                                     | 220P/500V CERAMIC | 42220P5ARJ  | 2    |
| C517   | 680P/500V CERAMIC | 42680P5ARJ  | 2    |
| C003, C004                                     | 01/500V CERAMIC   | 42103U5ARJ  | 2    |
| C501 - C508, C512,                             | 001 J MYLAR       | 41102U50RJ  | 9    |
| C601 - C608, C612                              | 001 J MYLAR       | 41102U50RJ  | 9    |
| C518, C519                                     | 0012 J MYLAR      | 41122U50RJ  | 2    |
| C315, C318, C415,                              | 0018 J MYLAR      | 41182U50RJ  | 3    |
| C418, C511, C512,                              | 0018 J MYLAR      | 41182U50RJ  | 3    |
| C611, C612                                     | 0018 J MYLAR      | 41182U50RJ  | 2    |
| C305, C405                                     | 002 J MYLAR       | 41202U50RJ  | 2    |
| C510, C610                                     | 0022 J MYLAR      | 41222U50RJ  | 2    |
| C515, C615                                     | 0027 J MYLAR      | 41272U50RJ  | 2    |
| C520   | 0047 J MYLAR      | 41472U50RJ  | 1    |
| C510, C610                                     | 0056 J MYLAR      | 41562U50RJ  | 2    |
| C618, C619                                     | 0068 J MYLAR      | 41682U50RJ  | 2    |
| C333, C433                                     | 0068 J MYLAR      | 41682U50RJ  | 2    |
| C304, C404                                     | 0082 J MYLAR      | 41822U50RJ  | 2    |
| C516, C614                                     | 047 J MYLAR       | 41473U50RJ  | 2    |
| C316, C317, C416,                              | 068 J MYLAR       | 41683U50RJ  | 3    |
| C417, C522                                     | 068 J MYLAR       | 41683U50RJ  | 2    |
| C617   | 12 J MYLAR        | 41124U50RJ  | 1    |
| C521   | 12 J MYLAR        | 41124U50RJ  | 1    |
| C305, C405                                     | 002 J MYLAR       | 41203U50RJ  | 2    |
| C617   | 082 J MYLAR       | 41823U50RJ  | 1    |
| C307, C407                                     | 0.47U/50V ELEC    | 40047U50RM  | 2    |
| C301, C322, C326,                              | 4.7U/25V ELEC     | 404P7U25RM  | 3    |
| C328, C330, C331,                              | 4.7U/25V ELEC     | 404P7U25RM  | 3    |
| C422, C426, C428,                              | 4.7U/25V ELEC     | 404P7U25RM  | 3    |
| C401, C430, C513,                              | 4.7U/25V ELEC     | 404P7U25RM  | 3    |
| C514, C614                                     | 10U/25V ELEC      | 40010U25RM  | 3    |
| C320, C322, C325,                              | 10U/25V ELEC      | 40010U25RM  | 3    |
| C327, C329, C332,                              | 10U/25V ELEC      | 40010U25RM  | 3    |
| C422, C427, C425,                              | 10U/25V ELEC      | 40010U25RM  | 3    |
| C432   | 10U/25V ELEC      | 40010U25RM  | 1    |
| C006   | 10U/50V ELEC      | 40010U50RM  | 1    |
| C324, C424                                     | 100U/25V ELEC     | 40100U25RM  | 2    |

| REF. NO              | DESCRIPTION           | P/N         | Q'TY |
|----------------------|-----------------------|-------------|------|
| C323, C423           | 220U/16V ELEC         | 40220U16RM  | 2    |
| C011, C012           | 2200U/16V ELEC        | 402K2U16RM  | 2    |
| C007, C008           | 2200U/25V ELEC        | 402K2U25RM  | 2    |
| C311, C411           | 100P/100V PP T        | 44100100PT  | 2    |
| C102, C202           | 200P/100V PP T        | 44200100PT  | 2    |
| C009, C010           | .01K/160V MPP D       | 44103160MD  | 2    |
| C013, C014           | .01K/100V P.S         | 43103100PS  | 2    |
| Z001                 | <b>DIODE</b>          |             |      |
| Z002, Z003           | 4.7V/0.5W             | 13Z047P5TO  | 1    |
| D001 - D007          | 15V/0.5W              | 13Z150P5TO  | 2    |
|                      | IN4002                | 13IN4002TO  | 7    |
| IC017                | <b>IC</b>             |             |      |
| IC018                | 7915A JRC             | 117915A***  | 1    |
| IC003, IC015, IC016, | 7815A JRC             | 117815A***  | 1    |
| IC020                | 2043SD NJM            | 112043SD*** | 3    |
| IC005 - IC014        | 2043SD NJM            | 112043SD*** | 1    |
| IC001                | 4558DD JRC            | 114558DD*** | 10   |
| IC002, IC019         | 5532DD JRC            | 115532DD*** | 1    |
| IC004                | 712JN JRC             | 11712JN***  | 2    |
|                      | 4556D NJM             | 114556D***  | 1    |
|                      | <b>TRANSISTOR</b>     |             |      |
| Q002                 | 2SA1015               | 122SA1015*  | 1    |
| Q001                 | 2SC1815               | 122SC1815*  | 1    |
| Q301, Q401           | 2SC3327               | 122SC3327*  | 2    |
|                      | <b>OTHERS</b>         |             |      |
| J207                 | WAFER 5045-2          | 6650452***  | 1    |
| J003                 | WAFER 5045-3          | 6650453***  | 1    |
| J013, J018,          | WAFER 5045-4          | 6650454***  | 2    |
| TVR701, TVR801       | TVR 500 Ω, 6φ         | 31500083HS  | 2    |
|                      | PIN 1x1x19            | 65010119**  | 6    |
|                      | P.C. BOARD B - 1171   | 97B1171***  | 1    |
|                      | WASHER, SPRING 3φ(Y)  | 88WS036P**  | 6    |
|                      | WASHER 3.2x10x1       | 88W031010*  | 2    |
|                      | FUSE CLIP 5φ (EXV)    | 67FH035***  | 4    |
|                      | FUSE CLIP 6φ          | 67FH036***  | 4    |
|                      | WAFER 52011-7         | 66520117**  | 2    |
|                      | WAFER 52011-9         | 66520119**  | 1    |
| F001, F002           | FLAT CABLE 3Px110 m/m | 823P110***  | 1    |
|                      | FLAT CABLE 7Px100 m/m | 827P100***  | 1    |
|                      | FLAT CABLE 8Px120 m/m | 828P120***  | 1    |
|                      | FLAT CABLE 9Px210 m/m | 829P210***  | 1    |
|                      | FUSE 6.3φX31.75X1A    | 59UL001A1F  | 2    |
|                      | FUSE 5φX20X1A EXV     | 59VDE01A1F  | 2    |

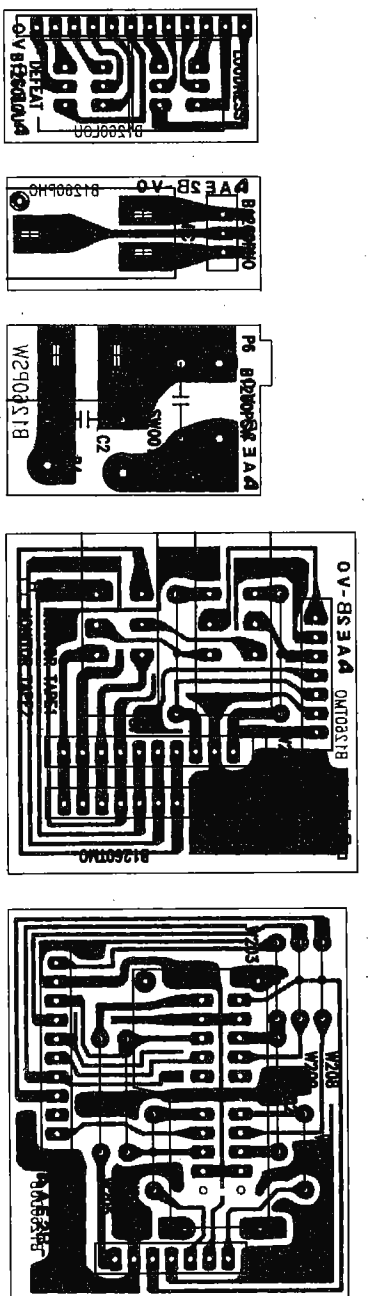

| REF. NO. | DESCRIPTION             | P/N        | Q'TY |
|----------|-------------------------|------------|------|
|          | WAFER 52011-7           | 66520117** | 1    |
|          | WAFER 52011-10          | 665201110* | 1    |
|          | FLAT CABLE 7Px130 m/m   | 827P130*** | 1    |
|          | P.C. BOARD B - 1260 TMO | 97B1260TMO | 1    |
|          | PUSH SWITCH SPUN22A002  | 20UN22A002 | 1    |

| REF. NO. | DESCRIPTION                   | P/N        | Q'TY |
|----------|-------------------------------|------------|------|
|          | PIN 1x1x19                    | 65010119** | 4    |
|          | P.C. BOARD B - 1260 PSW       | 97B1260PSW | 1    |
|          | CAPACITOR .0047/125V VDE TYPE | 49472U52** | 1    |
|          | PUSH SWITCH ESB - 8213V TV3   | 20UN24C004 | 1    |

| REF. NO. | DESCRIPTION             | P/N        | Q'TY |
|----------|-------------------------|------------|------|
|          | FLAT CABLE 7Px220 m/m   | 827P220*** | 1    |
|          | FLAT CABLE 10Px260 m/m  | 8210P260** | 1    |
|          | P.C. BOARD B - 1260 DUB | 97B1260DUB | 1    |
|          | PUSH SWITCH SRR2V43N25  | 20R2V43N25 | 1    |

| REF. NO. | DESCRIPTION             | P/N        | Q'TY |
|----------|-------------------------|------------|------|
|          | FLAT CABLE 6Px130 m/m   | 826P130*** | 2    |
|          | P.C. BOARD B - 1260 LOU | 97B1260LOU | 1    |
|          | PUSH SWITCH SPEC21HA02  | 20EC21HA02 | 1    |

| REF. NO. | DESCRIPTION                   | P/N         | Q'TY |
|----------|-------------------------------|-------------|------|
|          | P.C. BOARD B - 1260 LED ASS'Y | 97B1260LED  | 1    |
|          | FLAT CABLE 9Px130 m/m         | 829P130***  | 1    |
|          | FRAME, LED A - 380            | 78A380****  | 1    |
|          | LED 3φ, L - 32YD (4)          | 16032YD**** | 7    |
|          | LED 3φ, L - 32ED (4)          | 16032ED**** | 1    |

| REF. NO. | DESCRIPTION                   | P/N        | Q'TY |
|----------|-------------------------------|------------|------|
|          | P.C. BOARD B - 1260 PHO ASS'Y | 28JY631801 | 1    |
|          | PHONE JY6318-01-030           | 97B1260PHO | 1    |
|          | PVC WIRE #1007 24 260 m/m (0) | 72P7242500 | 1    |
|          | PVC WIRE #1007 24 340 m/m (2) | 72P7243402 | 1    |
|          | PVC WIRE #1007 24 340 m/m (0) | 72P7243406 | 1    |

thecarversite.com

thecarversite.com

©Copyright 1992 CARVER CORPORATION  
ALL RIGHTS RESERVED

Printed in Taiwan

P/N 990-20120-01  
Rev. A